

**Notes**

This drawing and information contained within is issued in confidence and is the copyright of GN Surveys. If the topographical information or base mapping has been supplied by a Third Party, GN Surveys is not liable for any inaccuracies contained therein. If inaccuracies to supplied mapping have been identified (and GN Surveys have not been commissioned to rectify these inaccuracies) these will be highlighted in the accompanying report. Disclosure of this information to Third Parties and unauthorised copying or replication of this data without approval is forbidden.

**Drawing Links**

Click on the below links for additional deliverables which can be used in unison with the drawing for a full desktop study of the project:  
 Drawings in DWG format [CLICK HERE](#)

**Overview**

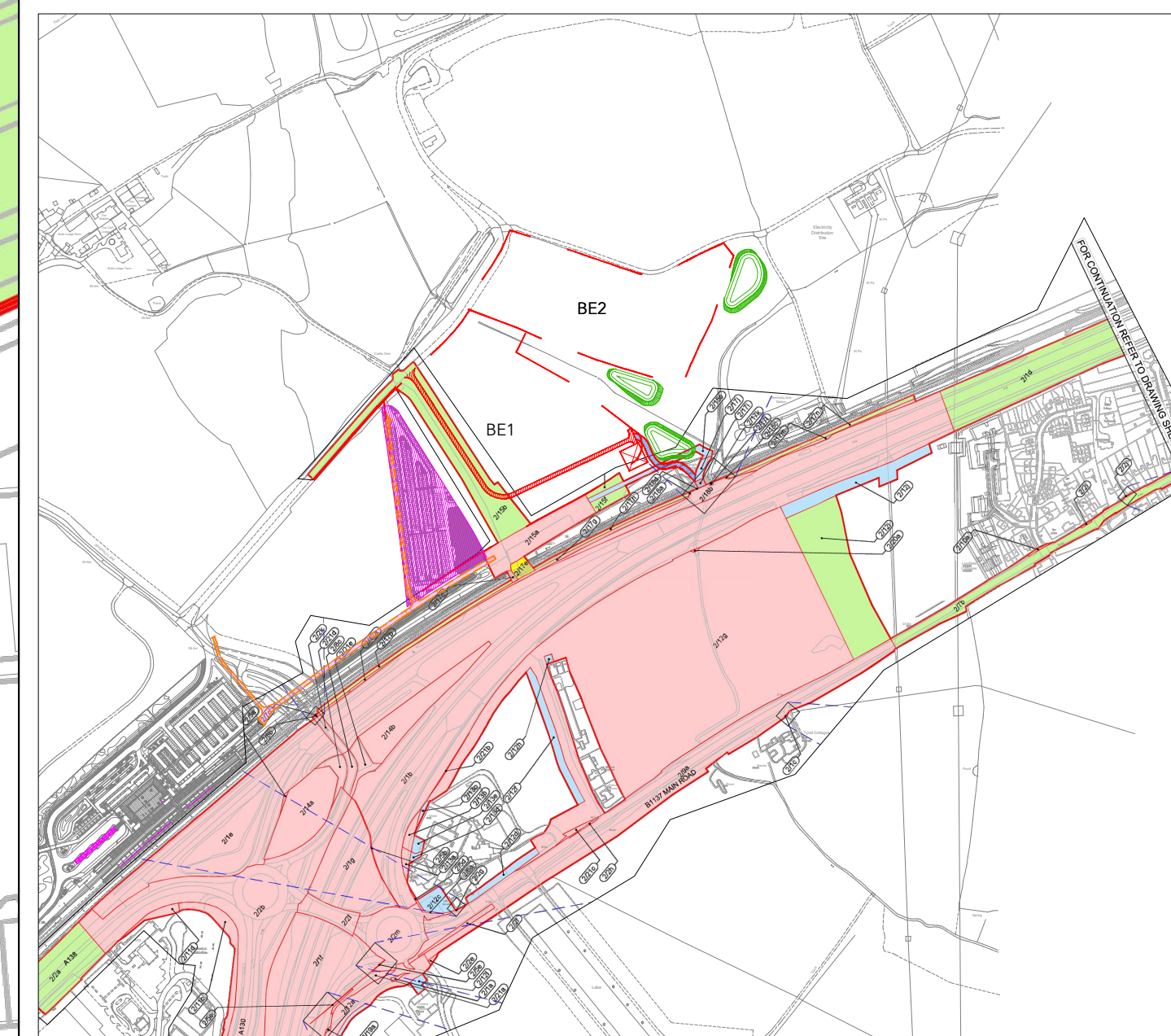

P01	ORIGINAL ISSUE	MO	GN	DT	09-02-2023
Rev.	Amendment	Drn.	Chkd.	Appd.	Date

Project **BEAULIEU**

Drawing **LAND TRANSFER PLAN SHEET 1 OF 1**

Client **COUNTRYSIDE**  
 Places People Love



7 Pappus House, Colchester, Essex, UK  
 operations@gnsurveys.co.uk

Scale at A0 - As Stated	Status: Draft
Project / Drawing No. Z03100-CP-NA-NA-SU-G-6053	Rev. P01

**BOREHAM INTERCHANGE OVERVIEW**